



## PYROBELITE 7

FIRE RESISTANT GLAZING EW 30  
ACCORDING TO EN13501-2

### DESCRIPTION

Pyrobelite 7 is a laminated glass assembled with one clear intumescent interlayer.  
In the event of fire, the interlayer transforms into a rigid and opaque fire shield, that keeps out flames and reduces heat transmission. Pyrobelite 7 and 7EG provide fire resistance in both directions.

### TECHNICAL DATA

Specification / Identification	Pyrobelite 7  yourglass.com	Pyrobelite 9 EG  yourglass.com	Pyrobelite 7 / 9 EG  yourglass.com
Glazing type	Single	Single	Double glazed
Grade	Internal	Internal / External	Internal / External
Glass thickness	7.9 mm	12.06 mm	min 23.6 mm
Thickness tolerance	± 0.9 mm	± 1.5 mm	± 2 mm
Dimension tolerance	± 2 mm	± 2 mm	± 3 mm
Weight	ca 17 kg/m <sup>2</sup>	ca 28 kg/m <sup>2</sup>	min 32 kg/m <sup>2</sup>
Minimum dimensions	No minimum	No minimum	200 x 400 mm
Light properties (EN 410): $\tau_v / \rho_v$ [%]	89/8	86/8	NPD
U value (EN 673)	5.7 W/(m <sup>2</sup> .K)	5.5 W/(m <sup>2</sup> .K)	NPD
Impact resistance (EN 12600)	3B3	1B1	NPD
Sound reduction (EN 12758): Rw(C, Ctr)	34 dB (0; -3)	37 dB (-1; -2)	NPD

NPD: No performance declared - see Glass Configurator on [www.yourglass.com](http://www.yourglass.com)

### CERTIFICATIONS according to EN 1364-1, EN 1634-1 & EN 13501-2

APPLICATION (*)	REPORT NUMBER	Glazing	Tested dimensions in mm l x h (**)			Results (minutes)	
			Portrait	Landscape	Surface	EW	EI
Partition	13409 B	Pyrobelite 7	1100 x 2874	1698 x 710	3.16 m <sup>2</sup>	44	10
	14891 B	Pyrobelite 7 IGU	1000 x 2874	1783 x 850	2.87 m <sup>2</sup>	42	13
	16015 A	Pyrobelite 9 EG	1100 x 2874	1683 x 850	3.16 m <sup>2</sup>	44	25
	R06277	Pyrobelite 7	1205 x 2005	1421 x 777	2.42 m <sup>2</sup>	37	8
	16406	Pyrobelite 7	1000 x 2860	1215 x 800	2.86 m <sup>2</sup>	37	9
	3P02372	Pyrobelite 7 IGU	900 x 2860	1875 x 800	2.57 m <sup>2</sup>	34	-
14V001922	Pyrobelite 9 EG	1096 x 1710	2240 x 1130	2.53 m <sup>2</sup>	37	-	

(\*) For alternative systems, please consult AGC

(\*\*) Extended application of results following EN 15254-4

# PYROBELITE 7

FIRE RESISTANT GLAZING EW 30 ACCORDING TO EN 13501-2

Timber frame (in mm)

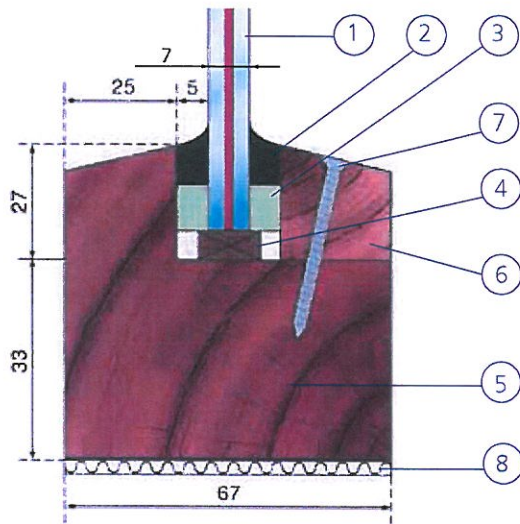

REPORT N° 13409 B

Steel frame (in mm)

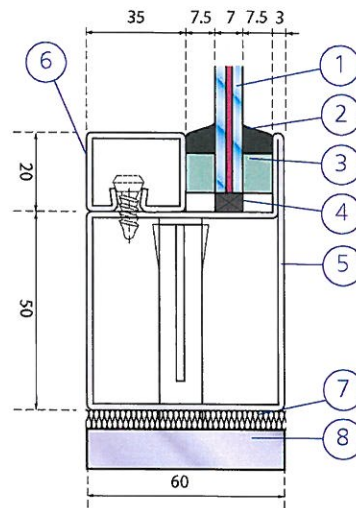

REPORT N° R06277

Example of assembly (in mm)  
Unlimited partition

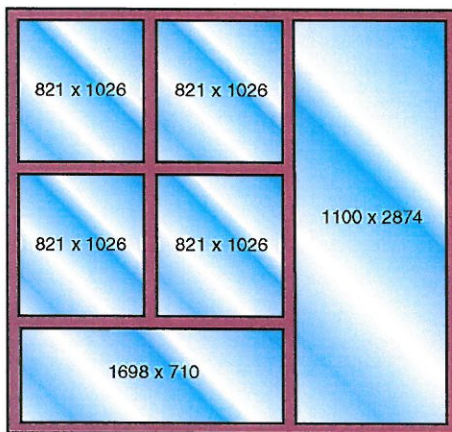

REPORT N° 13409 B

Example of assembly (in mm)  
Unlimited partition

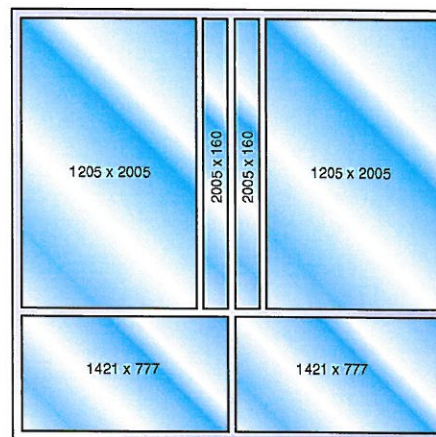

REPORT N° R06277

- 1 Pyrobelite 7
- 2 DC Firestop /00
- 3 Ceramic fibre paper: Superwool X607 15 x 5 mm
- 4 Setting block
- 5 Hardwood
- 6 Wooden Beads
- 7 Steel screw
- 8 Ceramic or mineral wool

- 1 Pyrobelite 7
- 2 Sealant DC 815
- 3 Ceramic fibre paper: Superwool X607 15 x 5 mm or Fiberfrax 15 x 4 mm
- 4 Setting block
- 5 Steel frame
- 6 Steel beads
- 7 Ceramic or mineral wool
- 8 Partition

Fire Resistant Glass - CHE-ENG - CDT's 1.0 - June 2015

All of the installation details given in the report must be respected. The only authorised modifications are those mentioned in the report.

[www.yourglass.com](http://www.yourglass.com)



GLASS UNLIMITED

AGC Glass Europe - plant Seneffe, Parc Industriel, Zone C, B-7180 Seneffe, Belgium, [pyrobel@eu.agc.com](mailto:pyrobel@eu.agc.com), Tel.: +32 64 51 05 19, Fax: +32 64 55 80 80  
AGC Glass Czech - plant Oloví, Sklářská 300, 357 07 Oloví, Czech Republic, [jan.vilcek@eu.agc.com](mailto:jan.vilcek@eu.agc.com), Tel.: +420 35 23 68 688, Fax: +420 35 23 68 66